

LUMENSOURCE



PL15 SR SERIES

The high brightness PL series comes in a 15W version and can be compared to a traditional plug-in fluorescent. The 4-pin base fits into any GX24q-2, GX24q-3, & GX24q-4 size fixture socket. It's integration with the aluminum backed heat sink provides high performance, energy saving, and long lasting light output.

SPECIFICATIONS

Wattage	15W
Voltage	120V or 277VAC
Average Lifetime	> 50,000 hrs
Colors	Warm White (3,000K) Cool White (5,000K)
Efficacy	1300 lm (W); 1400 lm (C)
Beam Angle	360 degrees
Dimensions	2" D / 5.75" L
LED	90
Socket	GX-24

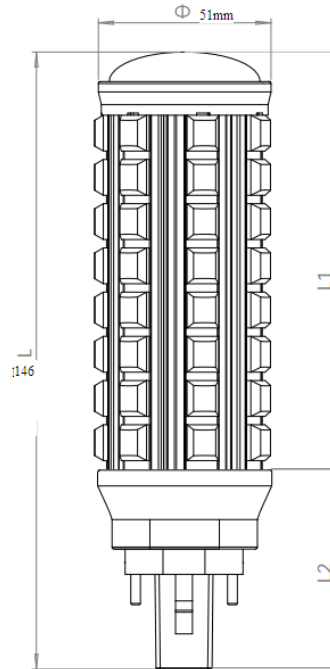

ORDERING INFO

4-pin Series

- PL15-SRX4-X

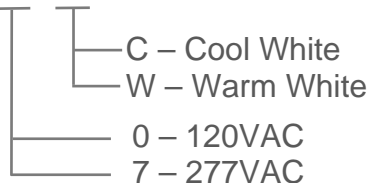

2-pin Series

- PL15-SRX2-X

