



LUMENSOURCE



STREET LIGHT MODULE 60 SERIES

Street light 60 uses only 60W with an exceptional light output of 4,000 lumens compared to traditional metal halide or high pressure sodium lamps. The module is built directly into a heat sink and elliptical lens that mounts directly into most cobra heads. Suitable for installations as high as 30ft street light poles providing high performance, energy saving, and long lasting light output.

FEATURES

- Rugged high performance heat sink
- Weatherproof housing with IP67 rating
- Withstands harshness of outdoor weather
- More brightness even at high location
- Virtually maintenance-free operation
- Low cost of ownership and operation
- No UV and flicker less operation

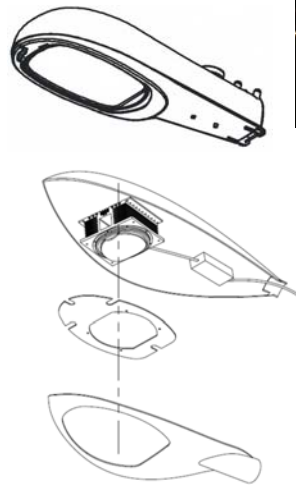

SPECIFICATIONS

Voltage	120-277V AC
Housing	Aluminum
Waterproof	IP67
Dimensions	8"L x 6.7"W x 5.3"H
Lumens	4,000 lm
LED	49
Color	Cool White (5,000K)

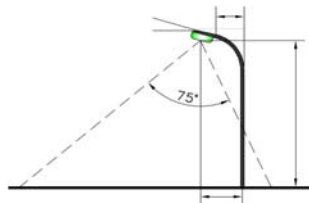
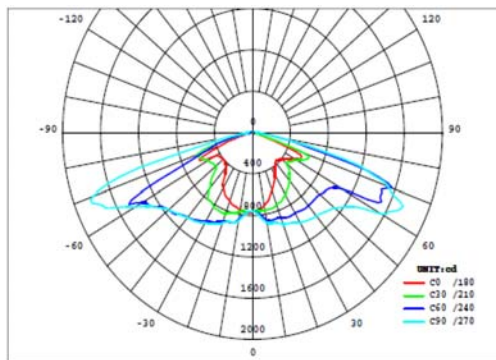
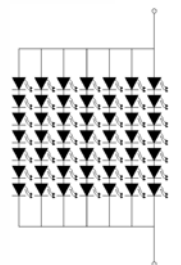
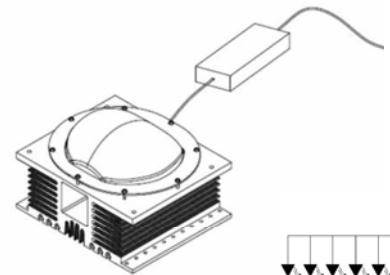
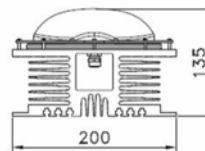
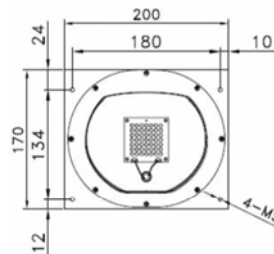

ORDERING INFO

- SLM-60-C

