

LUMENSOURCE

AUTO T10 AO SERIES

The high brightness T10 AO bulb uses only 2W compared to a 15W traditional halogen light source. The wedge base fits into any T10 automotive socket providing high performance, energy saving, and long lasting light output for brake lights and signal lights..

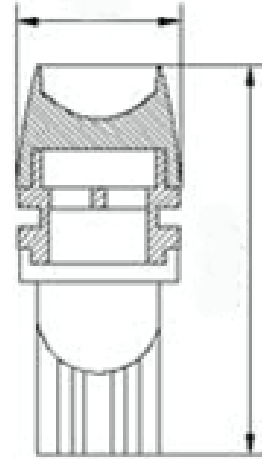

SPECIFICATIONS

Wattage	2W
Voltage	12V DC
Average Lifetime	> 50,000 hrs
Colors	Cool White (5,000K)
Luminous Flux	140 lm (WW); 160 lm (CW)
Beam Angle	60 degrees
Dimensions	0.47" dia / 1.12" length
Dimmability	Magnetic Low Voltage Dimmer
LED	1



ORDERING INFO

- T10D-AO15-C

